

Check All Dimensions on Site.

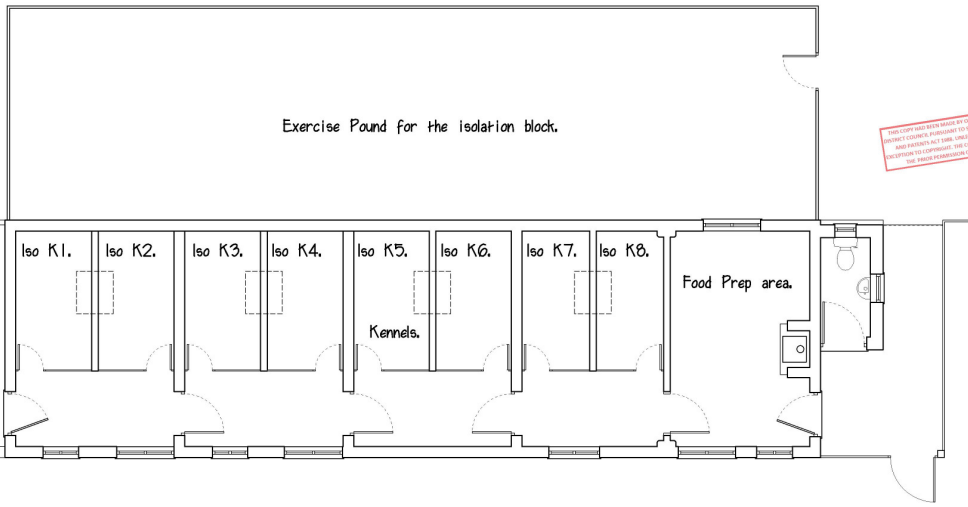

THIS COPY HAS BEEN MADE BY US WITH THE AGREEMENT OF THE
LOCAL COUNCIL. PLEASE DO NOT USE FOR ANY OTHER PURPOSES
AND PLEASE DO NOT MAKE ANY CHANGES TO THE DRAWING
WITHOUT THE WRITTEN PERMISSION OF THE COPYRIGHT OWNER.

REVISED PLAN

DATE
29/07/16

**MIKE PUNCHARD
PLAN DRAWING SERVICE**
9 THE AVENUE, NORTON, MALTON.
N. YORKS. YO17 9EF
TEL:- 01653 694276

TITLE :- Isolation Kennels.	AT :- Wintingham Common Farm, West Knapton.	
SCALES :- 1:50.	DATE :- Feb 2016.	DRAWING No. :- 15-1111-7.

Check All Dimensions on Site.

REVISED PLAN

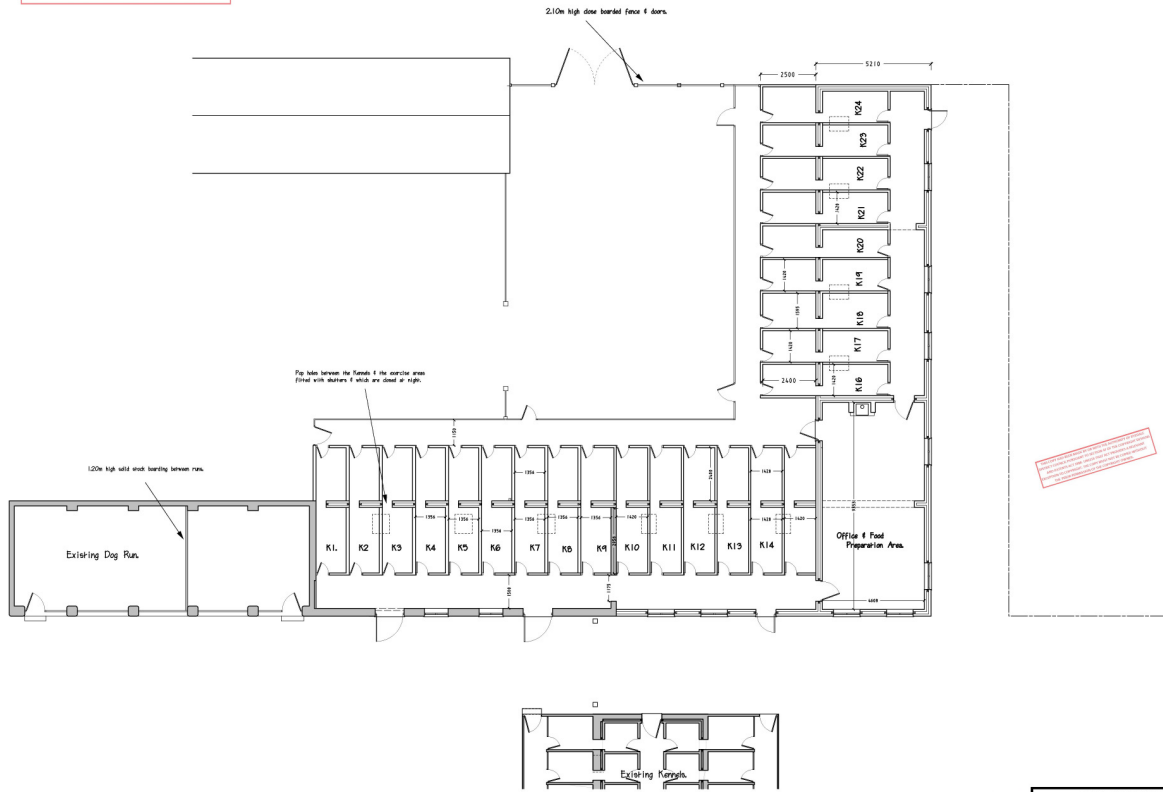

This drawing is the property of Mike PUNCHARD
 and is not to be used, copied or reproduced
 in any way without the written consent of
 Mike PUNCHARD.

DATE: 04/02/16

TITLE :- Proposed 24No Additional Dog Boarding Kennels. AT :- Wintringham Common Farm, West Knapton. FOR :- Mr & Mrs R. Stephenson.
 SCALES :- 1:75. DATE :- Feb 2016. DRAWING No. :- 15-1111-4.

MIKE PUNCHARD
PLAN DRAWING SERVICE
 9 THE AVENUE, NORTON, MALTON,
 N. YORKS. YO17 9EF
 TEL:- 01653 694276